

# ATLANTYK LB LED

INSTRUKCJA MONTAŻU | ИНСТРУКЦИЯ ПО МОНТАЖУ | MONTAGEANLEITUNG | INSTRUCTIONS DE MONTAGE | NÁVOD K MONTÁŽI | SZERELÉSI UTASÍTÁSOK  
 MONTERINGSVEJLEDNING | INSTRUÇÕES DE MONTAGEM | MONTERINGSVEJLEDNING | INSTRUCCIONES DE MONTAJE | KOKOONPANO - JA KIINNITYSOHJEET  
 MONTAGE INSTRUCTIE | INSTRUZIONI DI MONTAGGIO | ИНСТРУКЦІЯ З МОНТАЖУ | MONTAJ YÖNERGESİ

(PL) MONTAŻU POWINNA DOKONAĆ OSOBA POSIADAJĄCA ODPOWIEDNIE UPRAWNIENIA.

(GB) INSTALLATION MUST BE PERFORMED BY AN AUTHORIZED TECHNICIAN.

(F) LA MONTAGE DOIT FAIRE UNE PERSONNE QUI POSSEDER LES EXPERIENCES COMPETENTES.

(P) A INSTALAÇÃO TEM QUE SER FEITA POR UM TÉCNICO AUTORIZADO.

(RU) МОНТАЖ НУЖЕН БЫТЬ СОВЕРШЕН ЧЕРЕЗ ЛИЦО ИМЕЮЩЕ СООТВЕТСТВЕННЫЕ ПРАВА.

(D) DIE MONTAGE VON EINER PERSONE, DIE ÜBER ERFORDERLICHE KENNTNISE VERFÜGT GEMACHT WERDEN.

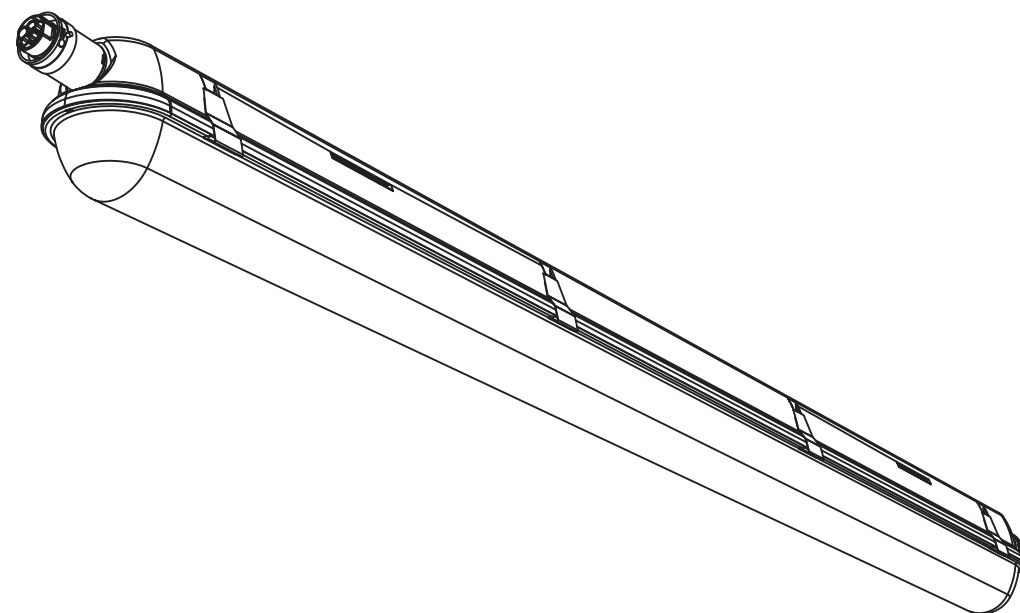



NIE OTWIERAĆ OPRAWY ! | DON'T OPEN !  
NE PAS OUVRIR LE CADRE ! | NÃO ABRIR !  
НЕ ОТКРЫВАТЬ СВЕТИЛЬНИКА !  
LEUCHTE NICHT ÖFFNEN !

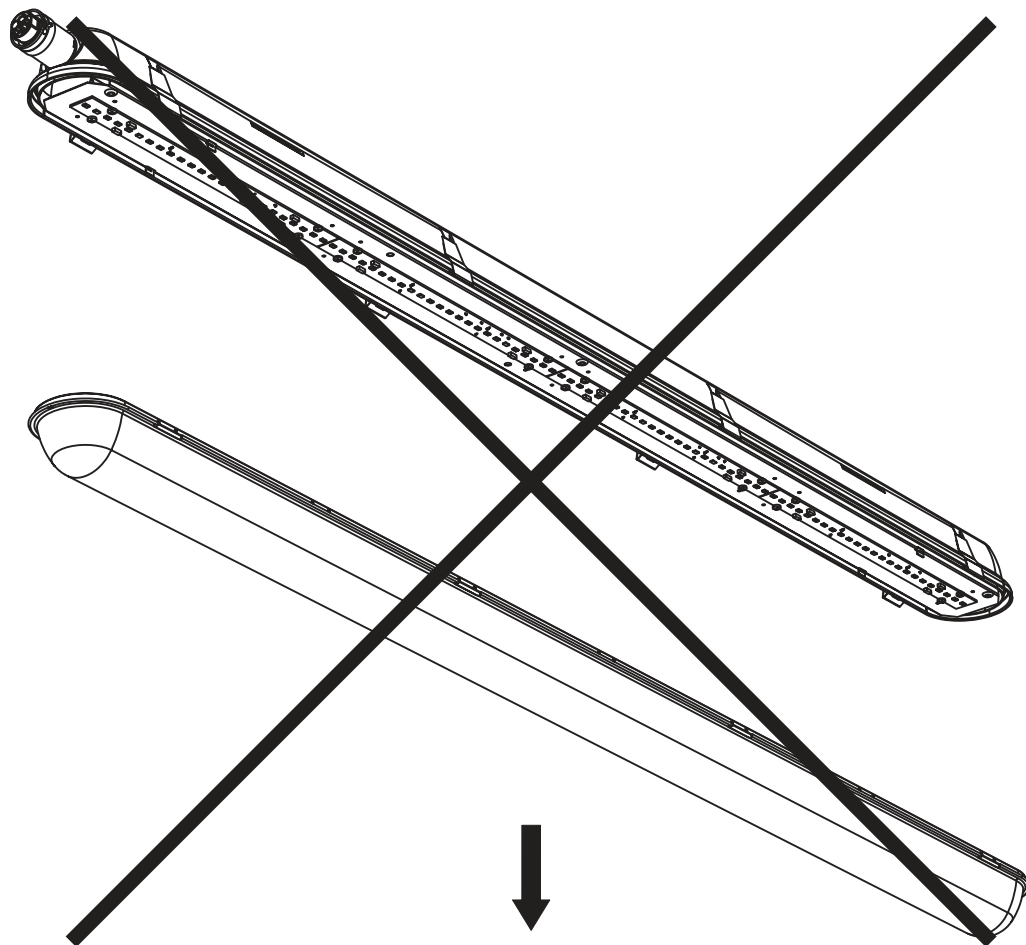

PODŁĄCZENIE ZASILANIA | POWER CONNECTION  
BRANCHEMENT D'ALIMENTATION | CONEXÃO DA ALIMENTAÇÃO  
ПОДКЛЮЧЕНИЕ ПИТАНИЯ | STROMVERSORGUNG

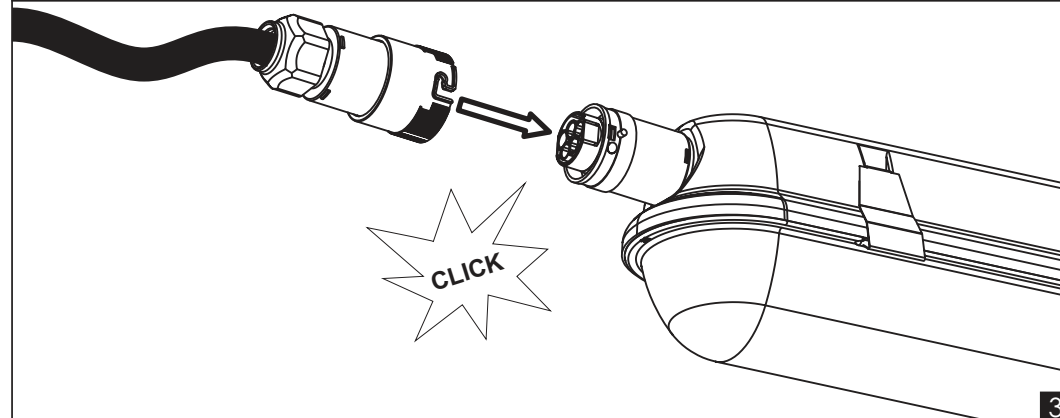

3

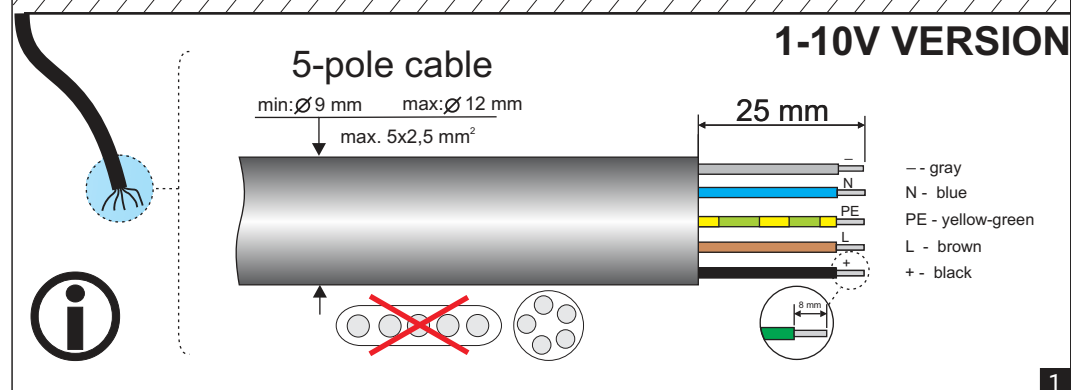

1

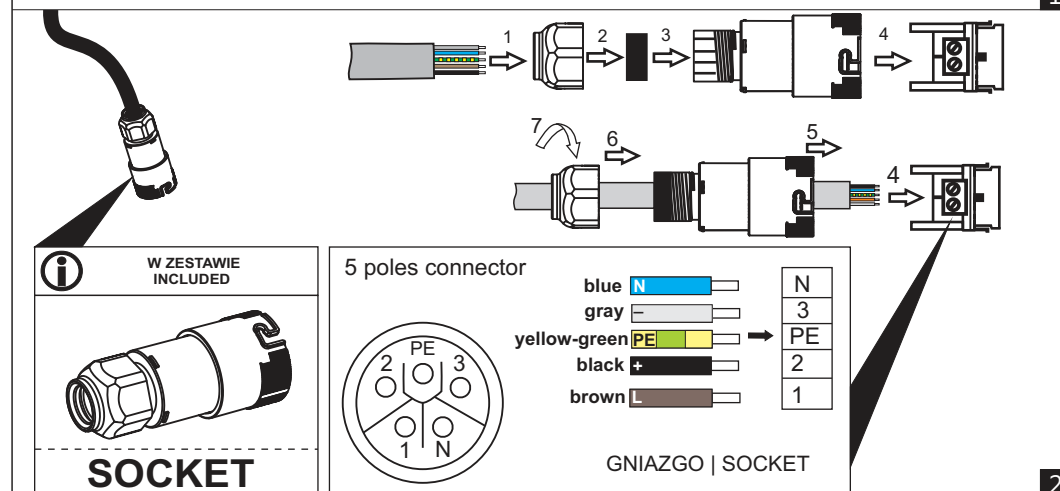

2

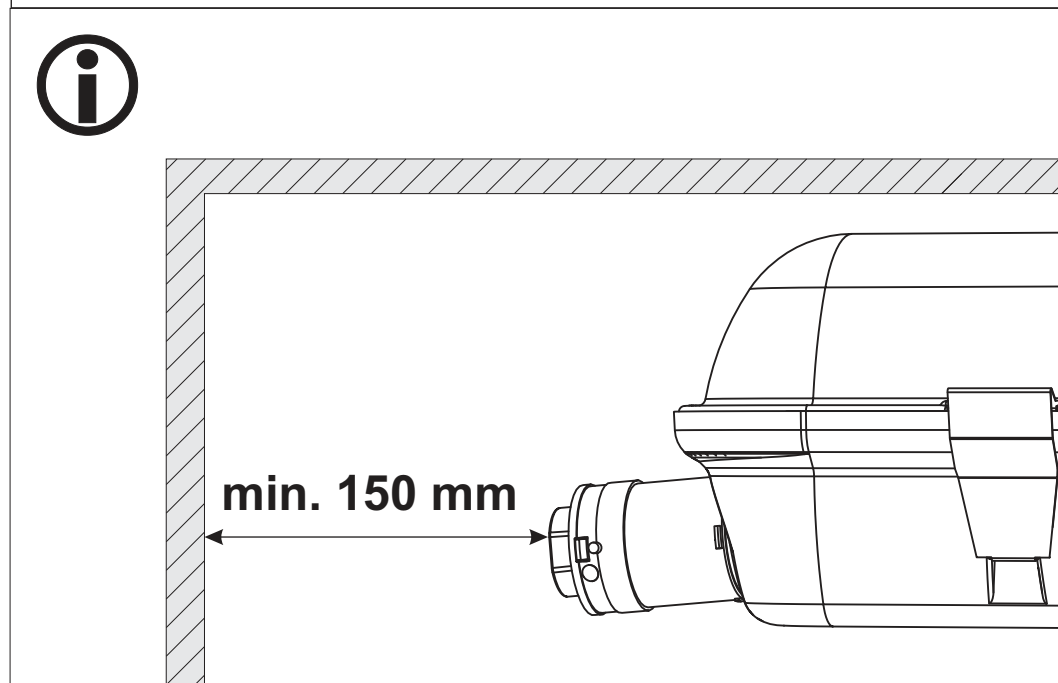
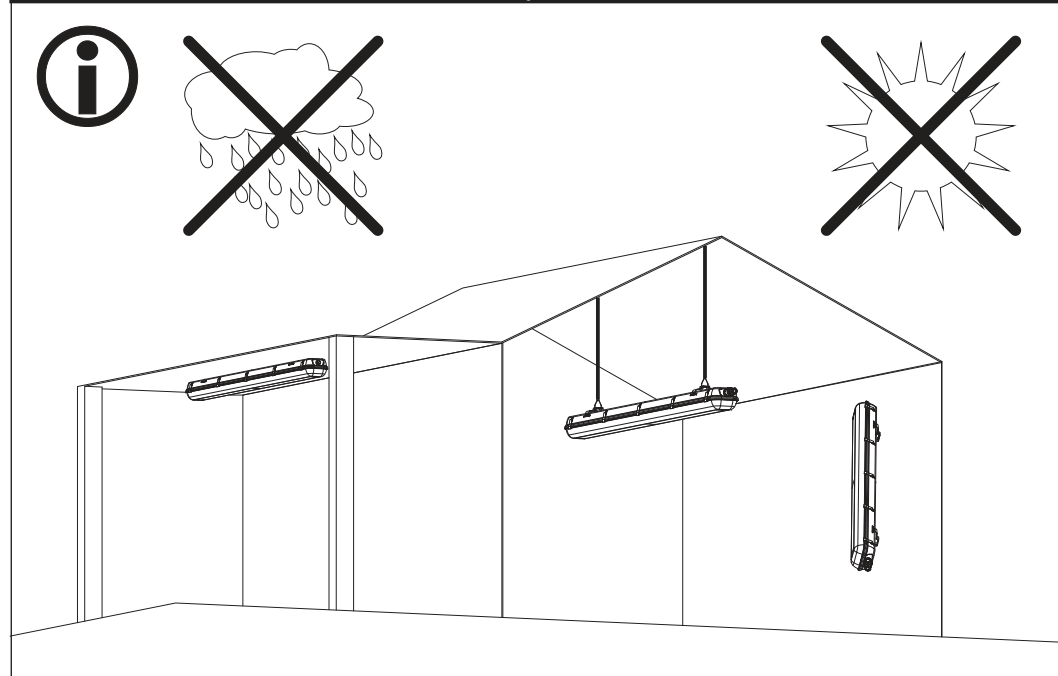
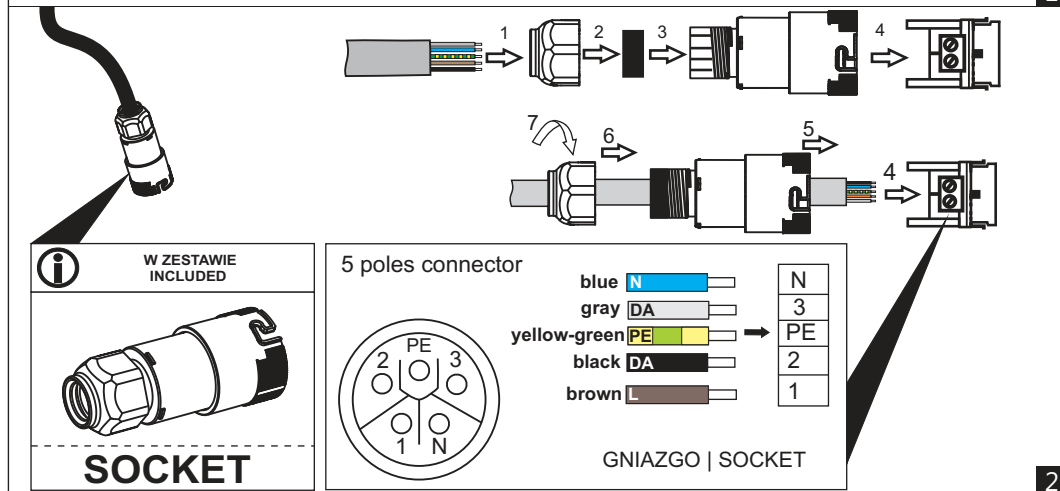
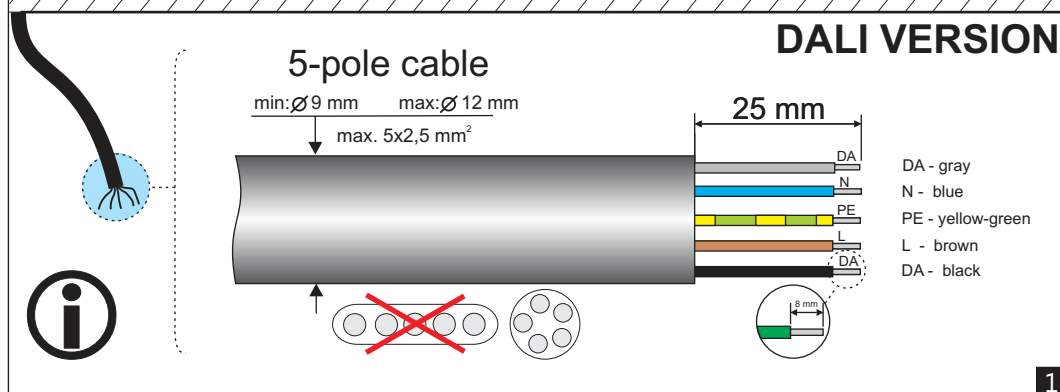
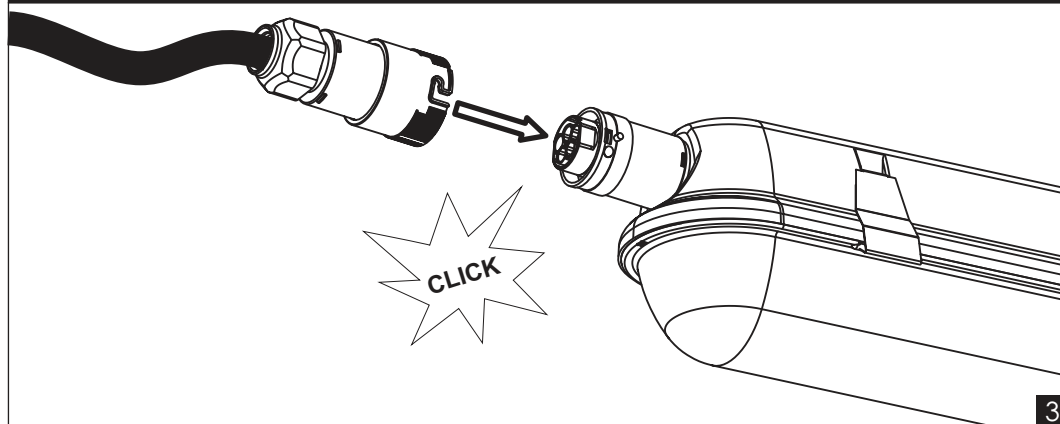

WERSJA ZWIESZANA | SUSPENDED VERSION  
VERSION SUSPENDUE | VERSÃO PENDENTE  
ВЕРСИЯ ПОДВЕШАЯ | PENDELVERSION

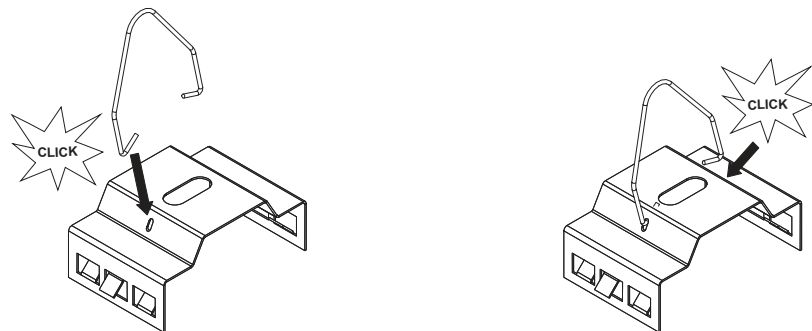

1

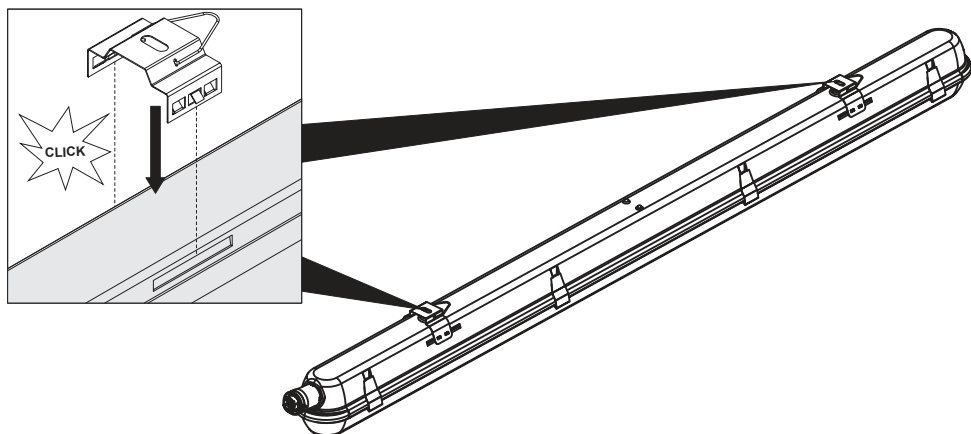

2

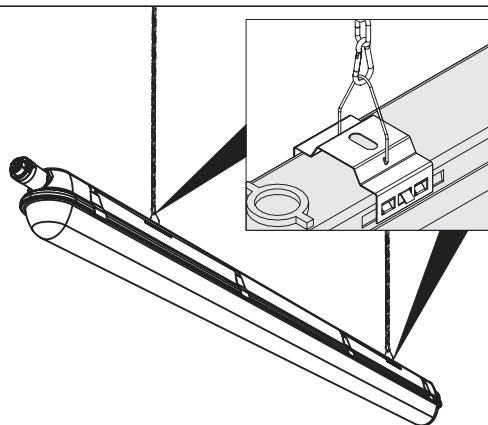

3

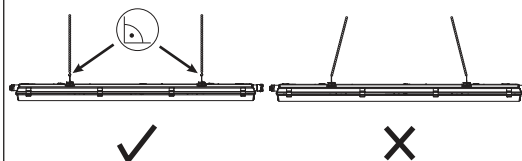

4

WERSJA N/T | SURFACE-MOUNTED VERSION  
VERSION N/T | VERSÃO PARA MONTAGEM DE SOBREPOR  
ВЕРСИЯ ПОТОЛОЧНАЯ | AUFBAUVERSION

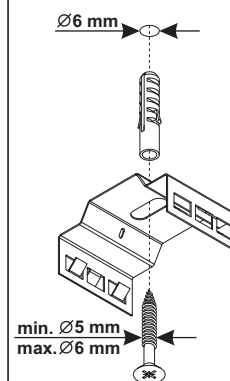

1

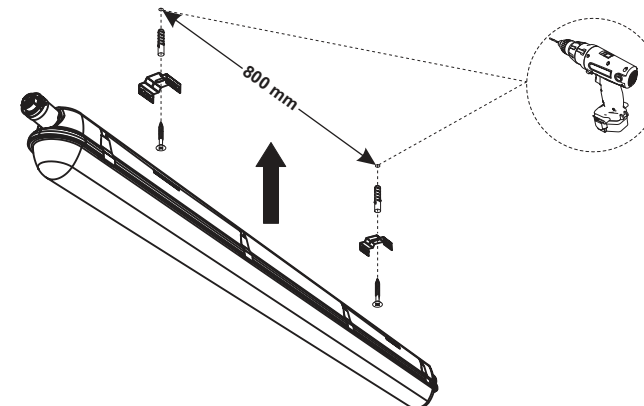

2

PODŁĄCZENIE ZASILANIA | POWER CONNECTION  
BRANCHEMENT D'ALIMENTATION | CONEXÃO DA ALIMENTAÇÃO  
ПОДКЛЮЧЕНИЕ ПИТАНИЯ | STROMVERSORGUNG

3-pole cable

STANDARD VERSION

min: Ø 7 mm max: Ø 12 mm  
max. 3x2,5 mm<sup>2</sup>

25 mm

N - blue  
PE - yellow-green  
L - brown

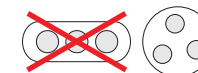

1

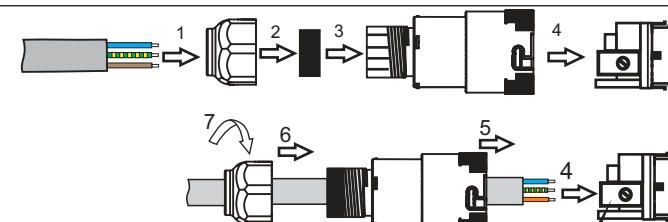

W ZESTAWIE  
INCLUDED

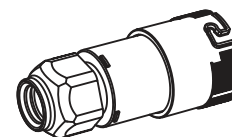

SOCKET

3 poles connector

blue N  
yellow-green PE  
brown L

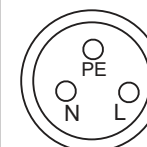

GNIAZGO | SOCKET

2